

SITE, GRADING, DRAINAGE, & EROSION CONTROL PLAN

UNIT 68 OF ABBEY SPRINGS CONDOMINIUM

LOCATED IN THE VILLAGE OF FONTANA-ON-GENEVA LAKE,
WALWORTH COUNTY, WISCONSIN

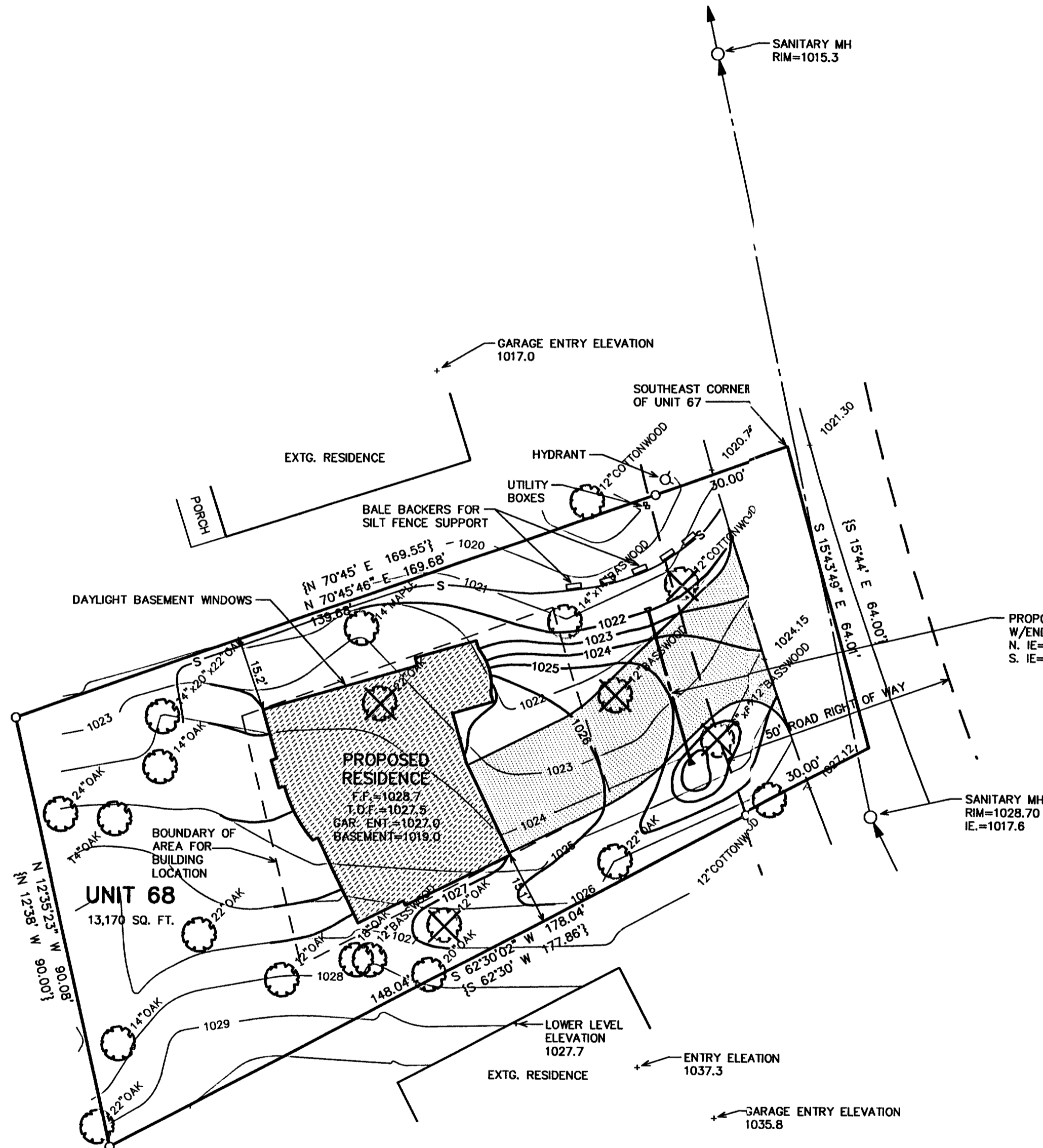
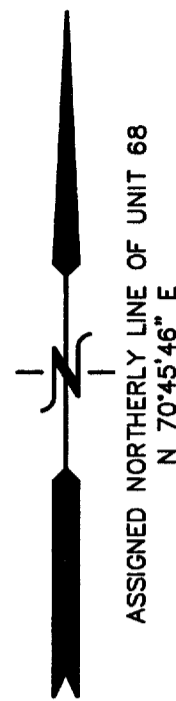

CONSTRUCTION SEQUENCE

- 1) SILT FENCING INSTALLED
- 2) VEGETATION TO BE CLEARED
- 3) TOPSOIL STRIPPED
- 4) FOUNDATIONS DUG & POURED
- 5) WALLS BACKFILLED
- 6) FRAMING & HOME CONSTRUCTION COMPLETED
- 7) DRIVE & LANDSCAPING COMPLETED

AREA TO BE RESTORED WITH TOPSOIL AS SOON AFTER FOUNDATION AND FRAMING AS POSSIBLE FOLLOWED WITH GRASS SEEDING AND MULCH.

NO LARGE TRIBUTARY DRAINAGE CROSSES THIS LOT, ONLY LOCALIZED LOT DRAINAGE.

AREA WITHIN SILT FENCING TO BE CLEARED OF UNDERBRUSH WITH ONLY NECESSARY LARGE TREES REMOVED.

NOTE: ALL SILT FENCING AND BALE CHECKS SHALL BE MAINTAINED IN A STABLE CONDITION FULLY BRACED AND STAKED TO PREVENT MOVEMENT BY RUNOFF UNTIL A DENSE TURF IS ESTABLISHED OVER ALL DISTURBED GROUND SURFACES. DURING OR AFTER EVERY STORM THEY SHALL BE CHECKED. ACCUMULATIONS OF SILT TOPSOIL AND ANY OTHER CONSTRUCTION DEBRIS SHALL BE ROUTINELY REMOVED.

LEGEND

- O = FOUND IRON PIPE STAKE
- {XXX} = RECORDED AS
- XXX--- = EXISTING CONTOURS
- XXX--- = PROPOSED CONTOURS
- S = PROPOSED SILT FENCE
- ⊗ = TREE TO BE REMOVED

NOTE: COPIES OF THIS MAP TO WHICH THE FOLLOWING CERTIFICATE WILL APPLY SHOW SURVEYOR'S ORIGINAL SEAL AND SIGNATURE IN RED INK. COPIES BY ANY OTHER MEANS MAY HAVE ALTERATIONS WHICH DO NOT REPRESENT THE SURVEYOR'S WORK PRODUCT.

I HEREBY CERTIFY THAT THE ABOVE DESCRIBED PROPERTY HAS BEEN SURVEYED UNDER MY DIRECTION AND THAT THE ABOVE MAP IS A TRUE REPRESENTATION THEREOF AND SHOWS THE SIZE AND LOCATION OF THE PROPERTY AND ITS EXTERIOR BOUNDARIES. THIS SURVEY IS MADE FOR THE USE OF THE PRESENT OWNERS OF THE PROPERTY, AND ALSO THOSE WHO PURCHASE, MORTGAGE, OR GUARANTEE THE TITLE THERETO WITHIN ONE YEAR FROM THE DATE HEREOF.

DATED: DEC. 18, 2000

Peter S. Gordon
PETER S. GORDON R.L.S. 2101

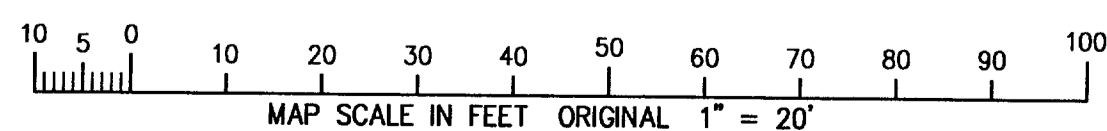
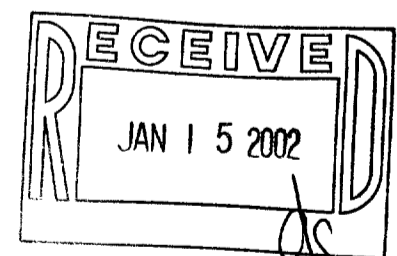

SITE, GRADING, DRAINAGE,
& EROSION CONTROL PLAN

WORK ORDERED BY -
MARK PEARLMAN
1015 NORTH CORPORATE CIRCLE
GRAYS LAKE, IL. 60030

FARRIS, HANSEN & ASSOCIATES, INC.
ENGINEERING - ARCHITECTURE - SURVEYING
7 RIDGWAY COURT P.O. BOX 437
ELKHORN, WISCONSIN 53121
OFFICE: (262) 723-2098 FAX: (262) 723-5886

REVISIONS

12/18/2001
ADD
SITE PLAN

PROJECT NO.
5720

DATE:
12/12/2001

SHEET NO.
1 OF 1

005-1964

SCDB 3-68

DEC 18 2001